



**FITTING INSTRUCTIONS FOR FP0120 FORK-PROTECTORS**  
**TRIUMPH TROPHY 2012**



**THIS KIT CONTAINS THE ITEMS PICTURED AND LABELLED BELOW.**  
**DO NOT PROCEED UNTIL YOU ARE SURE ALL PARTS ARE PRESENT.**

Please note that the way the kit is packed does not necessarily represent the way of mounting to the bike.

THE PARTS SHOWN MAY BE REPRESENTATIVE ONLY (FOR CLARITY OF INSTRUCTIONS ONLY)

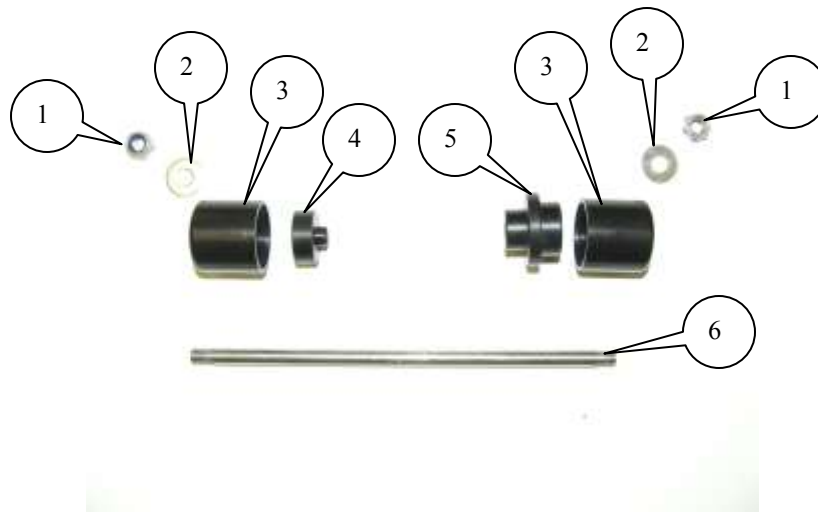



### **LEGEND**

- ITEM 1 = M8 NYLOC NUTS (x2).
- ITEM 2 = M8 WASHERS (19mm OUTSIDE DIAMETER) (x2).
- ITEM 3 = CRASH PROTECTORS (B0445M) (x2).
- ITEM 4 = LEFT-HAND SPACER (S0531) (x1).
- ITEM 5 = RIGHT-HAND SPACER (S0535) (x1).
- ITEM 6 = SPINDLE BAR (SB024=325mm LONG) (x1)

Please note that in cases where kits are packed with rubber washers holding the components onto the bolt – *the rubber washers should be thrown away!*

### **TOOLS REQUIRED**

- TWO 13mm A/F SOCKETS AND WRENCHES.

### **FITTING INSTRUCTIONS**

- PLACE SMALLER SPACER (S0531) INTO LEFT-HAND FRONT SPINDLE.
- PLACE LARGER SPACER (S0535) INTO RIGHT-HAND FRONT SPINDLE.
- FEED SPINDLE-BAR (SB024) THROUGH SPACERS IN FRONT SPINDLE.
- FIT BOTH CRASH-PROTECTORS OVER EITHER END OF SPINDLE BAR.
- FIT WASHERS AND NYLOC NUTS ONTO EITHER END OF SPINDLE BAR.
- TIGHTEN UNTIL BOTH NUTS ARE ENGAGED IN NYLON AND EQUAL AMOUNTS PROTRUDE FROM EITHER SIDE. DO NOT OVER-TIGHTEN—THE NYLOC NUTS WILL HOLD IT TIGHT.

ISSUE 1 22/11/2012 (NSY)

### **CONSUMER NOTICE**

The catalogue description and any exhibition of samples are only broad indications of the Products and R&G may make design changes which do not diminish their performance or visual appeal and supplying them in such state shall conform to the order. The Buyer acknowledges no representation or warranty (other than as to title) has been given or will apply to the Products other than those in R&G's order or confirmation and the Buyer confirms it has chosen the Products as being of merchantable quality and suitable for its particular purposes. Where R&G fits the Products or undertakes other services it shall exercise reasonable skill and care and rectify any fault free of charge unless the workmanship has been disturbed. The Buyer is responsible for ensuring that the warranty on the motorcycle is not affected by the fitting of the Products. On return of any defective Products R&G shall at its option either supply a replacement or refund the purchase money but shall not be liable if the Products have been modified or used or maintained otherwise than in accordance with R&G's or manufacturer's instructions and good engineering practice or if the defect arises from accident or neglect. Other than identified above and subject to R&G not limiting its liability for causing death and personal injury, it shall not be liable for indirect or consequential loss and otherwise its liability shall be limited to the amounts paid by the Buyer for the Products or the fitting or service concerned. These terms do not affect the Buyer's statutory rights.

### **R&G RACING RETURNS POLICY (NON-FAULTY GOODS)**

Returns must be pre-authorized (if not pre-authorized the return will be rejected). Goods may only be returned direct to us if they were purchased direct from us (customer must prove if necessary). Otherwise to be returned to original vendor. Goods must be in re-sellable condition, in the opinion of R&G Racing. All returns are subject to a 25% restocking and handling fee (25% of the gross value exc. P&P – at the prevailing price at time of purchase). The customer must pay any and all carriage charges. No returns of discontinued products, unless within 14 days of purchase. This policy does not affect your statutory rights and does not refer to faulty goods.

R&G Racing  
Unit 1, Shelley's Lane, East Worldham, Alton, Hampshire, GU34 3AQ  
Tel: +44 (0)1420 89007 Fax: +44 (0)1420 87301 [www.rg-racing.com](http://www.rg-racing.com) Email: [info@rg-racing.com](mailto:info@rg-racing.com)



**FRANCE**  
**INSTRUCTIONS DE MONTAGE DE LA PROTECTION**  
**TRIUMPH TROPHY 2012**

Merci de noter que les pièces assemblées dans l'emballage ne sont pas nécessairement dans le sens du montage à réaliser sur la moto.

**LEGENDE**

- ARTICLE 1 = Ecrou M8 NYLOC (x2).  
ARTICLE 2 = Rondelle M8 (dia externe 19mm) (x2).  
ARTICLE 3 = Tampon de protection (B0445M) (x2).  
ARTICLE 4 = Entretoise Gauche (S0531) (x1).  
ARTICLE 5 = Entretoise Droite (S0535) (x1).  
ARTICLE 6 = Barre (SB0024) (x1)

**OUTILS NECESSAIRES**

- 2 clés de 13mm.

**INSTRUCTIONS**

- PLACER L'ENTRETOISE LA PLUS PETITE (S0531) DANS LE COTE GAUCHE DE L'AXE DE ROUE AVANT.
- PLACER L'ENTRETOISE LA PLUS GRANDE (S0535) DANS LE COTE DROIT DE L'AXE DE ROUE AVANT.
- GLISSER LA BARRE (SB024) A TRAVERS LES DEUX ENTRETOISES.
- PLACER LES TAMPONS SUR CHAQUE COTE DE L'AXE.
- GLISSER UNE RONDELLE ET VISSER A LA MAIN UN ECROU SUR CHAQUE COTE DE LA PROTECTION.
- SERRER LES 2 ECROUS SIMULTANEMENT. NE PAS SERRER TROP FORTEMENT, LES ECROUS AUTOBLOQUANTS GARDERONT LES PROTECTIONS EN PLACE.